

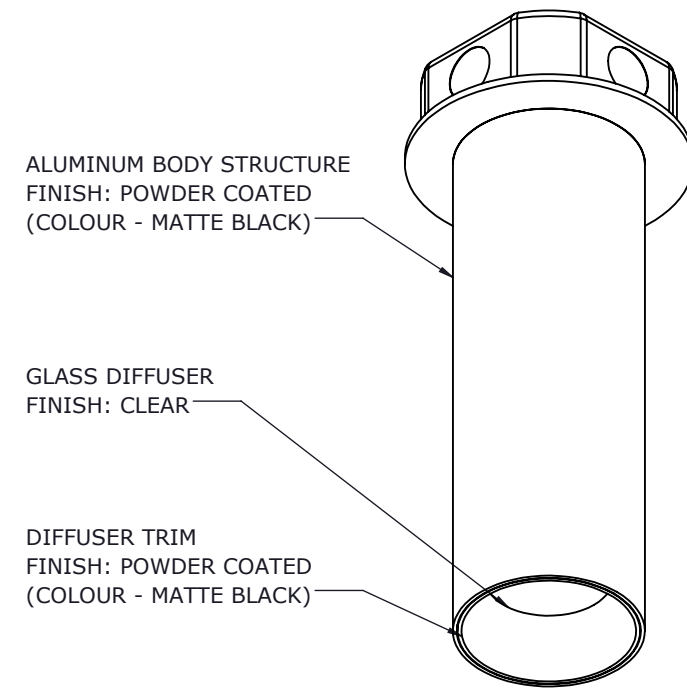

TUBO DIRECT - CEILING MOUNT - (DOWN LIGHT)
 LGN-C719-LED-CHR
 QTY:20

REVISIONS		
REV.	DESCRIPTION	DATE
0	ISSUED FOR APPROVAL	2021-04-06

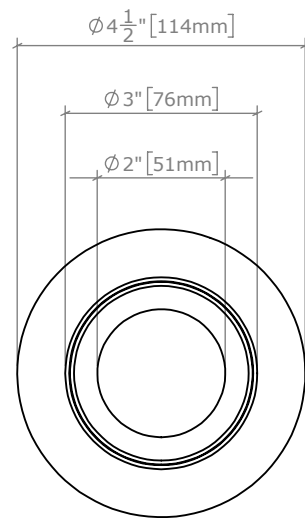
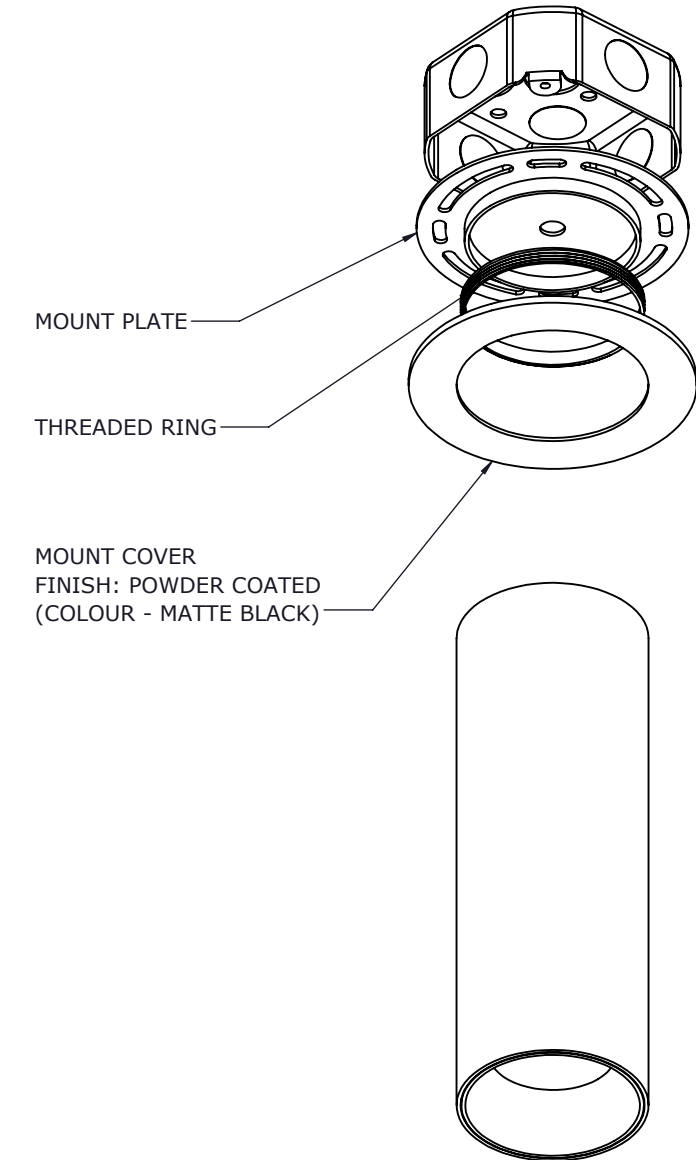
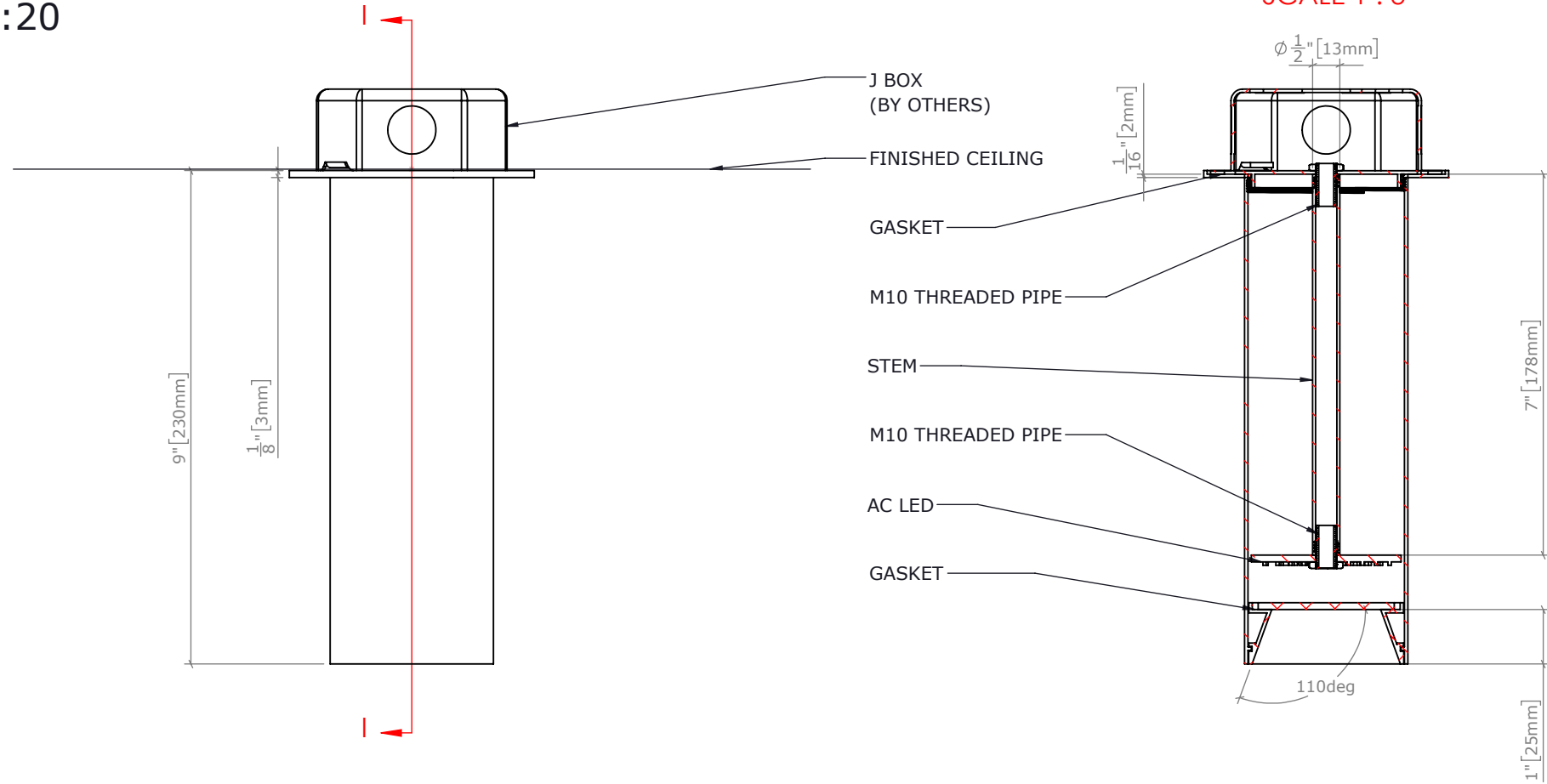

LAMPING:
 AC LED BOARD 7W, 700LM, 4000K, CRI 90
 TRIAC DIMMING

NOTES:
TRIAC DIMMING
FINISHES AVAILABLE IN BLACK, WHITE, CHROME
IP65 RATED

PROJECT: TUBO	SALES: FL	MODEL: C719
LAMP: AC LED 7W, 700LM, 4000K, CRI 90	CERT.: ETL	WEIGHT: ±7LBS VOLT:120V
DWG:OC24238	BY: AA DATE: 2021-04-06	SCALE: 1:3

TUBO DIRECT - CEILING MOUNT - (DOWN LIGHT)
 LGN-C719-GU10-CHR
 QTY:20

REVISIONS		
REV.	DESCRIPTION	DATE
0	ISSUED FOR APPROVAL	2021-04-06

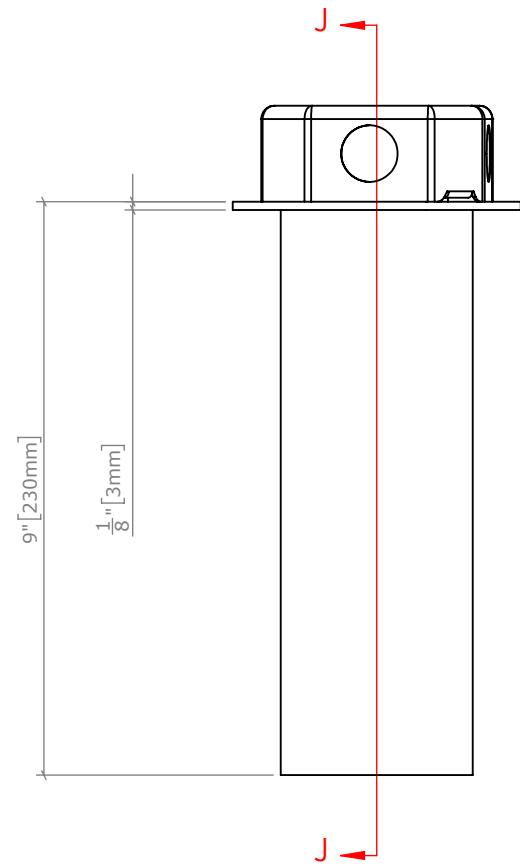

SECTION J-J
 SCALE 1 : 3

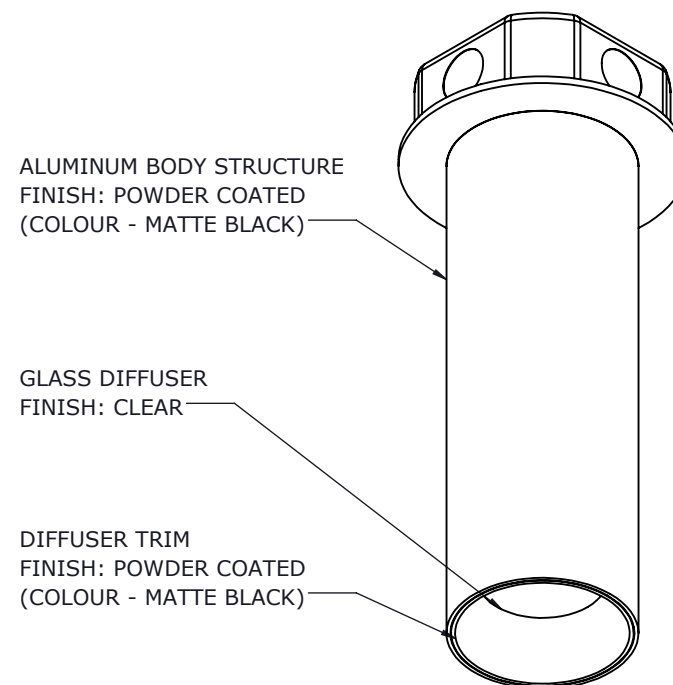
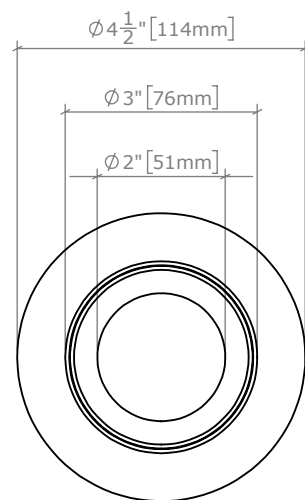
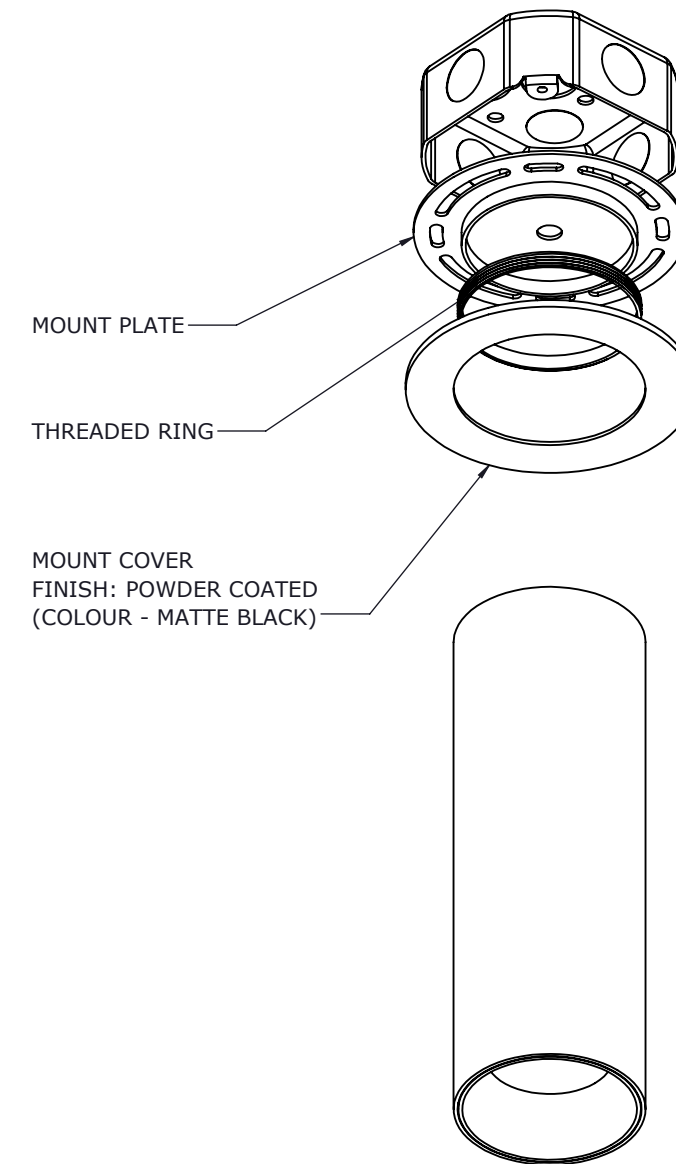
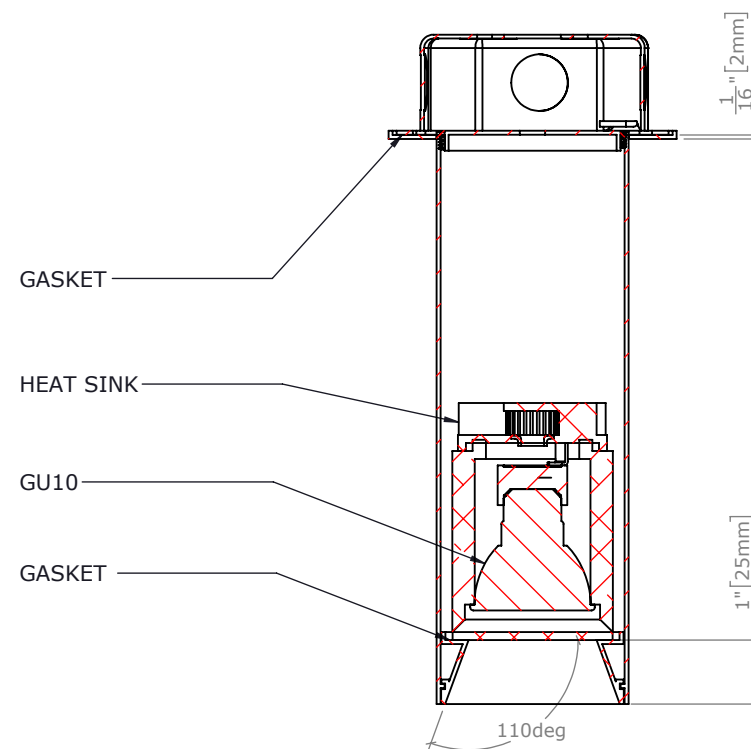

LAMPING: GU-10 BASE 50W
 SUGGEST: GU-10 BASE 50W, 500LM, 4000K, CRI90
 DIMMABLE BULB
 TRIAC DIMMING

PROJECT: TUBO	SALES: FL	MODEL: C719
LAMP: GU-10 BASE 50W	CERT.: ETL	WEIGHT: ±7LBS VOLT:120V
DWG:OC24238	BY: AA DATE: 2021-04-06	SCALE: 1:3

NOTES:
TRIAC DIMMING
FINISHES AVAILABLE IN BLACK, WHITE, CHROME
IP65 RATED